

# “LuxVent Plus”

Centrifugal Shower Ventilation Kit with Light

- for Ceiling Installation
- Complete Kit
- with or without Timer
- standard White **and** optional Chrome light fitting



*ventilation*

Uniclass L7534

**NEW**



**IPX7**



## GENERAL FEATURES

- centrifugal in-line ventilation kit designed to extract safely over longer distances from toilets, shower cubicles and bath rooms
- complete kit contains:
  - centrifugal in-line fan with mounting bracket
  - gasket
  - 90° bend
  - 6m flexible ducting
  - fixing screws, plugs and cable ties
  - brown grille for outside wall
  - low voltage ceiling light with white bezel included (chrome bezel optional)
  - 12v transformer for light installation
- timer adjustable between 3 and 30 minutes
- easy to install and maintain - fan can be accessed without removing ducting
- high performance extract capacities and pressures
- low noise levels
- suitable for continuous running
- ceiling light is SELV low voltage - **IPX7** - for additional safety when installing in Zone I
- ceiling light fitted with 35w sealed dichroic lamp
- fan made of shock proof, high quality tech polymer, flame retarding V2
- fan with double insulated motor mounted on self-lubricating, sealed ball bearings for long life
- backward curved blades for low sound
- fan and motor assembly balanced for quiet and vibration free operation
- fan motor windings protected to Class B
- fan motor incorporates thermal cut-out
- maximum ambient temperature - 50°C
- Complies with
  - EN60335-2-80
  - EC Low Voltage Directive 73/23-93/68
  - EC Directive EMC89/336
- CE marked

### RANGE

- LuxVent Plus**
  - standard model
- LuxVentT Plus**
  - as above with timer

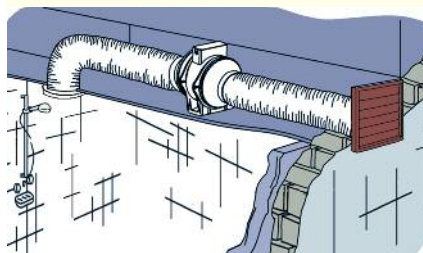

## TYPICAL SPECIFICATION

Supply and install a Vectaire LuxVentT Plus in-line centrifugal ventilation kit with light and over-run timer as supplied by Vectaire Ltd, Lincoln Road, Cressex Business Park, High Wycombe, Bucks, HP12 3RH.

The kit should include a centrifugal in-line fan with mounting bracket, 6m of flexible ducting a rubber gasket, 90° bend, fixing screws, plugs and cables, brown outside wall grille, 12v transformer and a ceiling light with a white bezel. The timer should be adjustable between 3 and 30 minutes.

The fan should be made of shockproof and heat resistant plastic, contain a motor with sealed, self-lubricating bearings, and be protected with a thermal cut-out. It should be possible to access the fan for maintenance without removing the ducting.

The fan should be double insulated and the light should be SELV low voltage making it suitable for installation into Zone I. It should comply with all current IEE, EC and Building Regulations requirements.

## TECHNICAL CHARACTERISTICS

Model	m <sup>3</sup> /hr	litres/sec	Max mm H <sub>2</sub> O	Max Pa	Volts	Hz	Watts	dbA	Hole dia mm
LuxVent	200	56	28	275	230	50	60	36	100

## DIMENSIONS

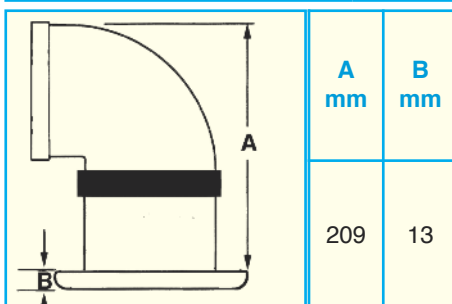
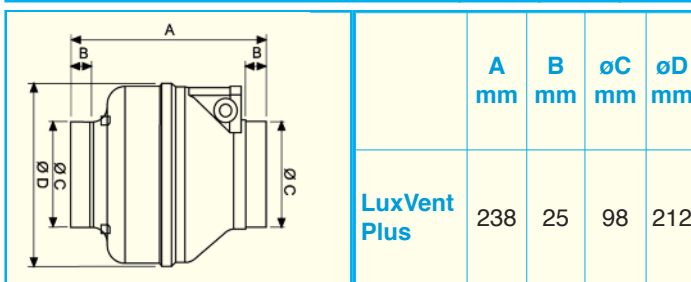
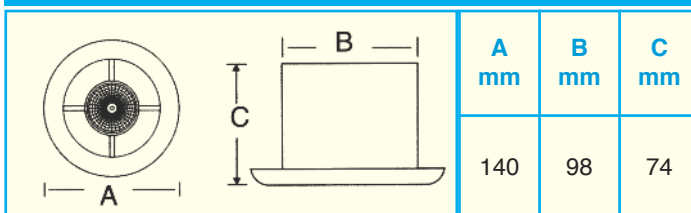

## PRESSURE

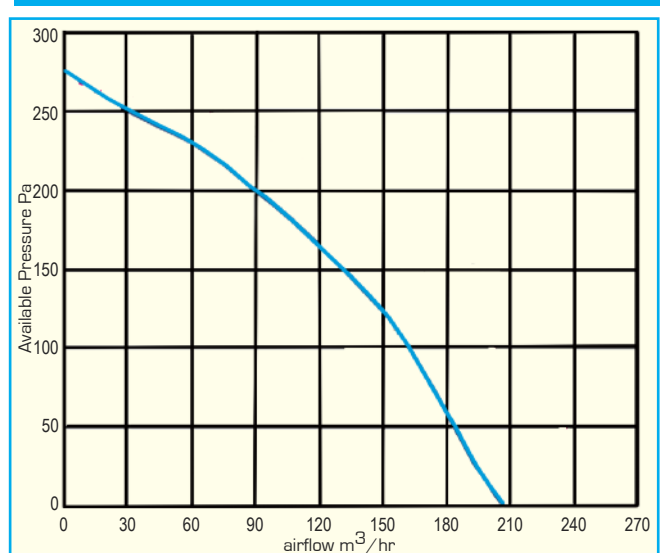

## Vectaire Ltd

Lincoln Road  
Cressex Business Park  
High Wycombe  
Buckinghamshire  
HP12 3RH

Tel: +44(0)1494 522333  
Fax: +44(0)1494 522337

Email: [sales@vectaire.co.uk](mailto:sales@vectaire.co.uk)  
Web: [www.vectaire.co.uk](http://www.vectaire.co.uk)

